

## 523 SERIES SURFACE MOUNT POWER INDUCTORS

## 3308 Size

- Ferrite Bobbin/Drum core.
- Compact dimensions.
- Very stable inductance over current range.
- Ideal for Reflow Soldering.
- Tape and reel standard packaging.\*

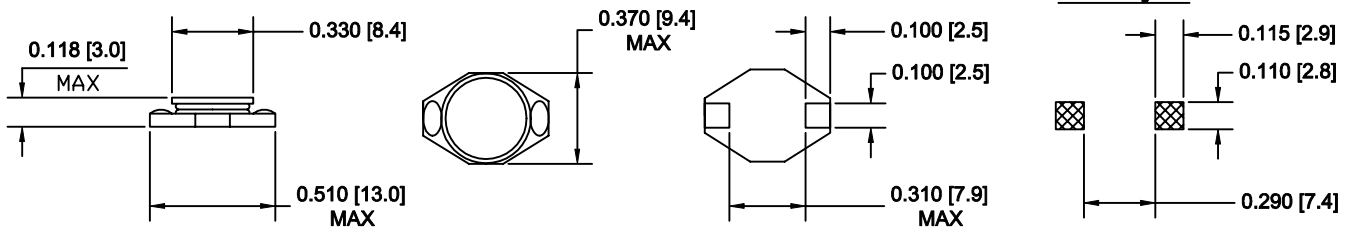

PART NUMBER	INDUCTANCE ( $\mu$ H) +/-20%	RATED CURRENT (A)	DCR ( $\Omega$ ) max.	SRF (MHz) typ.
523-3308-100M	10	2.00	0.11	35.0
523-3308-150M	15	1.50	0.15	33.0
523-3308-220M	22	1.30	0.23	25.0
523-3308-330M	33	1.10	0.30	19.0
523-3308-470M	47	0.80	0.39	14.0
523-3308-680M	68	0.70	0.66	12.0
523-3308-101M	100	0.60	0.84	10.0
523-3308-151M	150	0.50	1.20	8.0
523-3308-221M	220	0.40	1.90	6.0
523-3308-331M	330	0.30	2.70	5.0
523-3308-471M	470	0.20	4.00	4.0
523-3308-681M	680	0.10	5.30	3.0
523-3308-102M	1000	0.05	8.40	2.5

- Notes:
1. Inductance is tested at 100KHz using an HP4284A LCR meter.
  2. DCR is measured using an HP4338A Milliohm meter.
  3. SRF is measured using an HP3577A Network analyzer.

\* Reel contains 1000 pcs on a 13" reel.