

## 523 SERIES SURFACE MOUNT POWER INDUCTORS

## 3316 Size

- Ferrite Bobbin/Drum core.
- High Current capacity.
- Compact dimensions.
- Very stable inductance over current range.
- Ideal for Reflow Soldering.
- Tape and reel standard packaging.\*
- Low resistance and high energy storage.

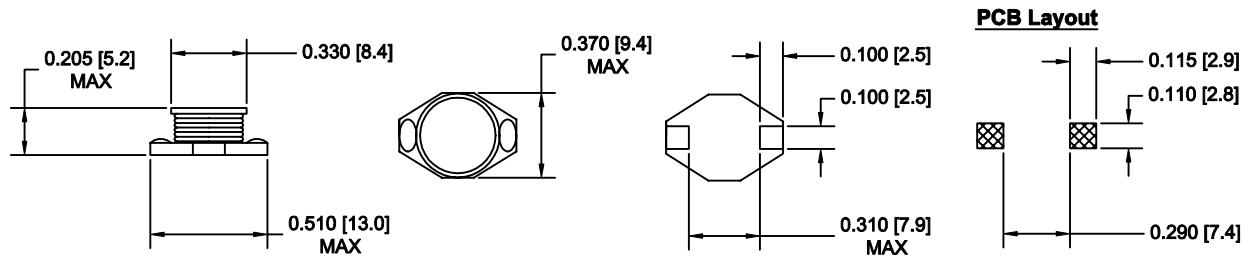

PART NUMBER	INDUCTANCE ( $\mu$ H) +/-20%	RATED CURRENT (A)	DCR ( $\Omega$ ) max.	SRF (MHz) typ.
523-3316-1R0M	1.0	6.8	0.009	100.0
523-3316-1R5M	1.5	6.4	0.010	90.0
523-3316-2R2M	2.2	6.1	0.012	80.0
523-3316-3R3M	3.3	5.4	0.015	65.0
523-3316-4R7M	4.7	4.8	0.018	45.0
523-3316-6R8M	6.8	4.4	0.027	38.0
523-3316-100M	10.0	3.9	0.038	30.0
523-3316-150M	15.0	3.1	0.046	27.0
523-3316-220M	22.0	2.7	0.085	19.0
523-3316-330M	33.0	2.1	0.100	15.0
523-3316-470M	47.0	1.8	0.140	12.0
523-3316-680M	68.0	1.5	0.200	10.0
523-3316-101M	100.0	1.3	0.280	9.0
523-3316-151M	150.0	1.0	0.400	6.0
523-3316-221M	220.0	0.8	0.610	5.0
523-3316-331M	330.0	0.6	1.020	4.5
523-3316-471M	470.0	0.5	1.270	3.5
523-3316-681M	680.0	0.4	2.020	2.5
523-3316-102M	1000.0	0.3	3.000	2.0

- Notes: 1. Inductance is tested at 100KHz using an HP4284A LCR meter.  
 2. DCR is measured using an HP4338A Milliohm meter.  
 3. SRF is measured using an HP3577A Network analyzer.

\* Reel contains 1000 pcs on a 13" reel.